

Newstart Motion Industries Ltd.

NEMA 34 Brake

PN: MPC034-24-003-T

- All dimensions are in inch [mm] unless otherwise noted.
- Sheet Scale 2:3
- Undimensioned features are per 3D file for reference use.
- Unless otherwise specified untoleranced dimensions are nonbasic and default to:

X.XX: ± .010" [0.25mm]
 X.XXX: ± .005" [0.125mm]
 Angles: ± 1°

Wire Length: 19.7 [500] ±.79 [20]
 Wire Gauge: 22AWG

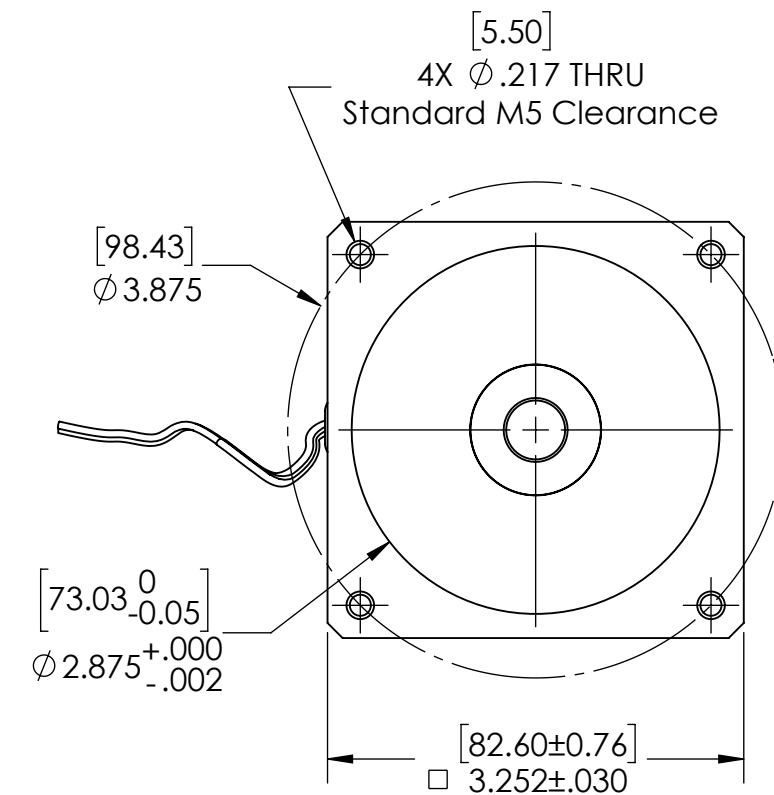
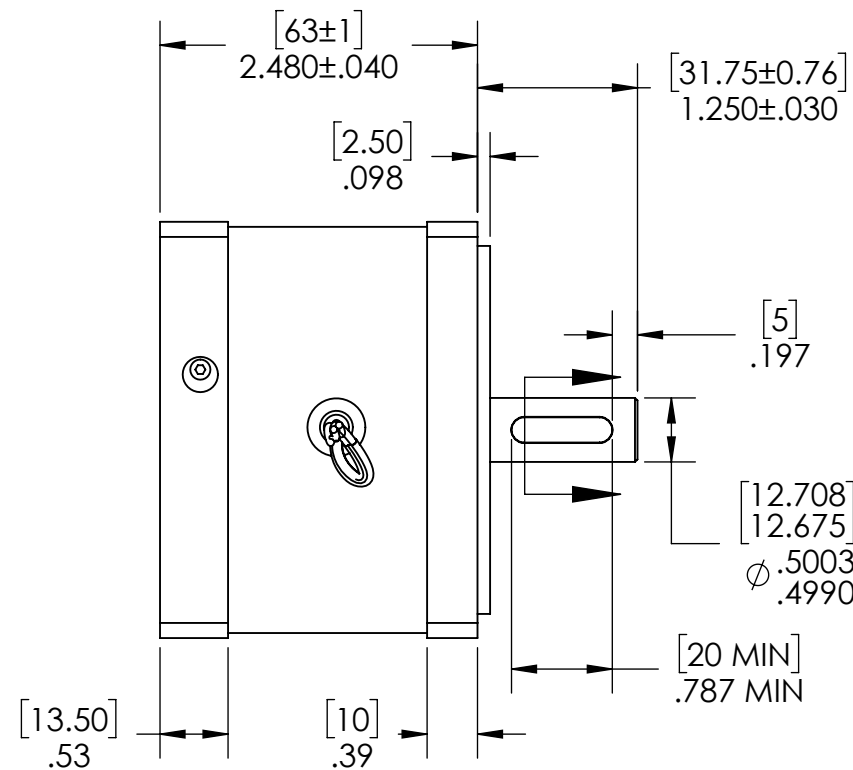
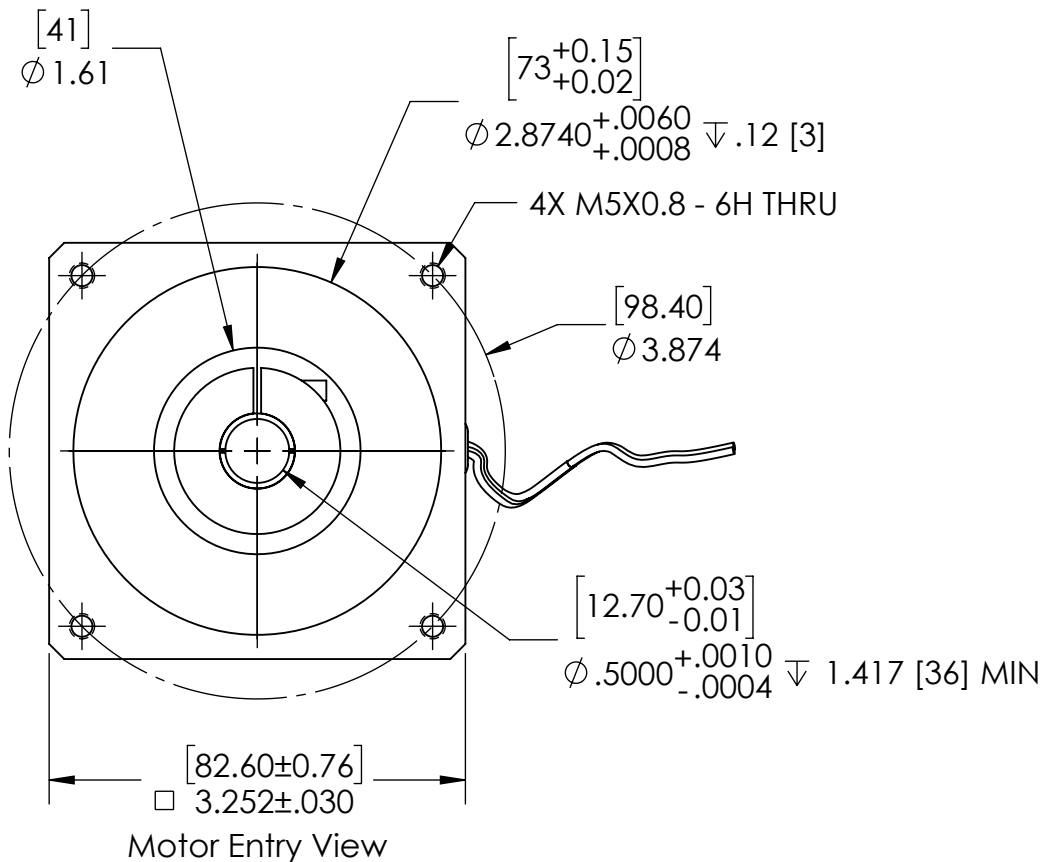
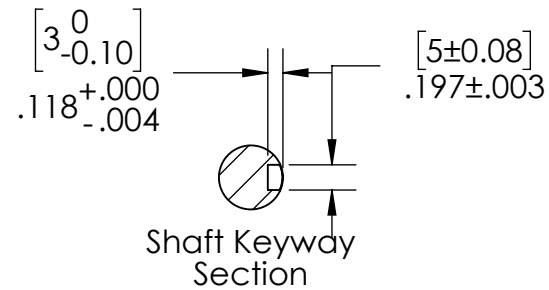
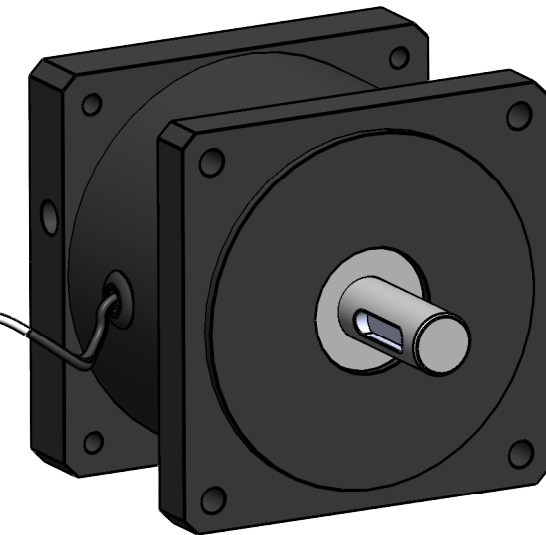

Performance Specifications:

- Braking Torque: 1.68Nm
- No-speed Actuation Cycles: 300,000
- Emergency-stop Actuation Cycles: 150,000
- Brake Engagement Time: 10ms
- Brake Disengagement Time: 20ms
- Environmental Sealing Rating: IP54

Input Requirements:

- Nominal Input Voltage: 24VDC
- Current Draw @20°C & 24V: 0.41 Amps
- Minimum Actuation Voltage: 20VDC
- Maximum Ambient Temperature: 60°C

Teknic, Incorporated

Victor, NY 14564 USA

This document and related electronic files are the sole property of Teknic, Incorporated and contain proprietary information.

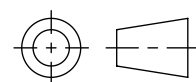

Third-Angle Projection

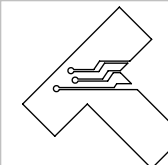

Additional documentation including product specifications, up-to-date compliance information, and manuals can be downloaded from Teknic's website.

Visit <https://www.teknic.com/> to access that documentation.

PART NO. MPC034-24-003-T

TITLE: NEMA 34 Brake

1 of 1 Sheets