

# Teknic ClearPath<sup>®</sup> - IP66K/IP67

## Fractional HP, DC Input

### NEMA 23

All dimensions are in inch [mm] unless otherwise noted.  
Sheet Scale 1:1

Unless otherwise specified, untoleranced dimensions default to:  
**X.XX:** ± 0.010" [.25mm]  
**X.XXX:** ± 0.005" [.125mm]

Model Number	L
CPM-____-231_-_-_-	3.591 [91.21]
CPM-____-232_-_-_-	4.339 [110.21]
CPM-____-233_-_-_-	5.087 [129.21]
CPM-____-234_-_-_-	5.835 [148.21]

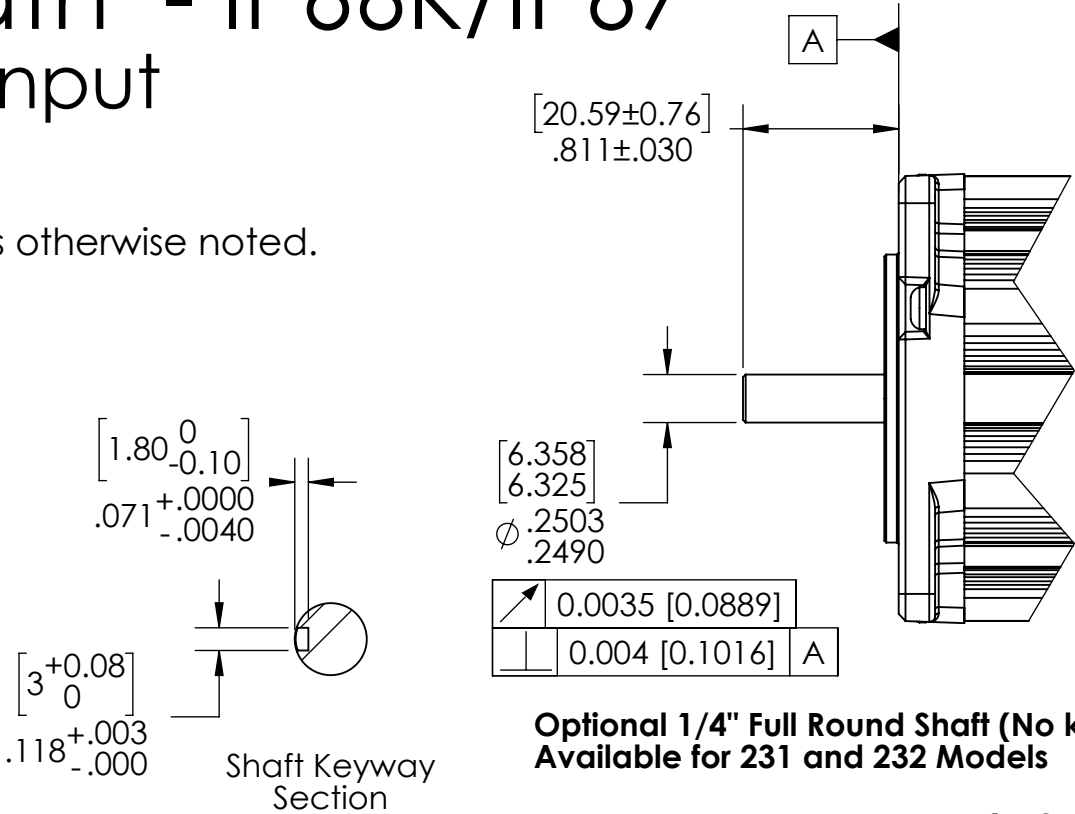

Optional 1/4" Full Round Shaft (No keyway)  
Available for 231 and 232 Models

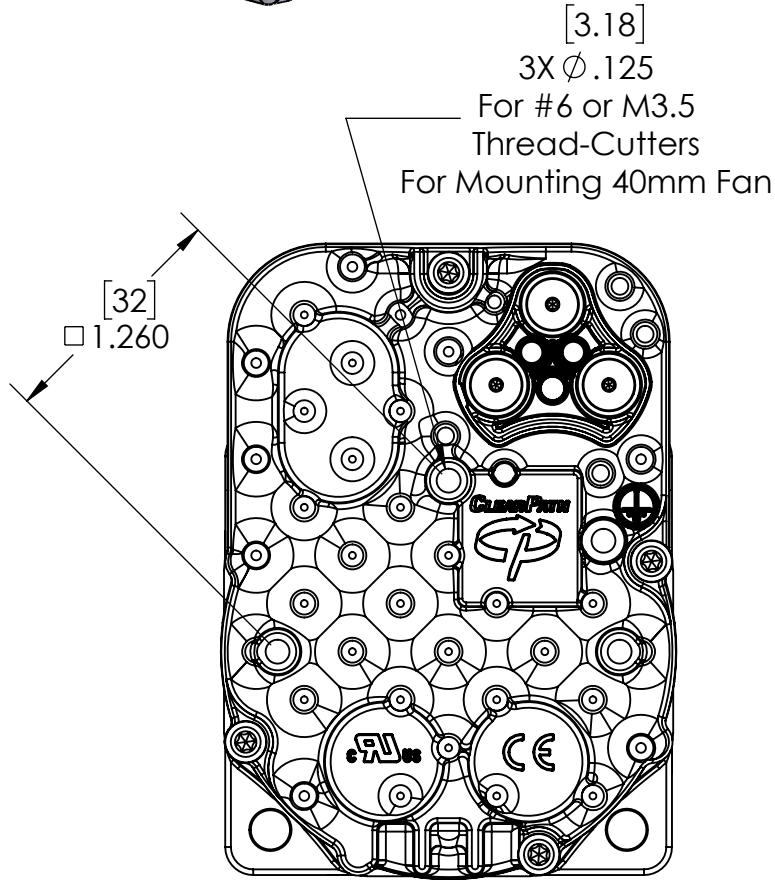
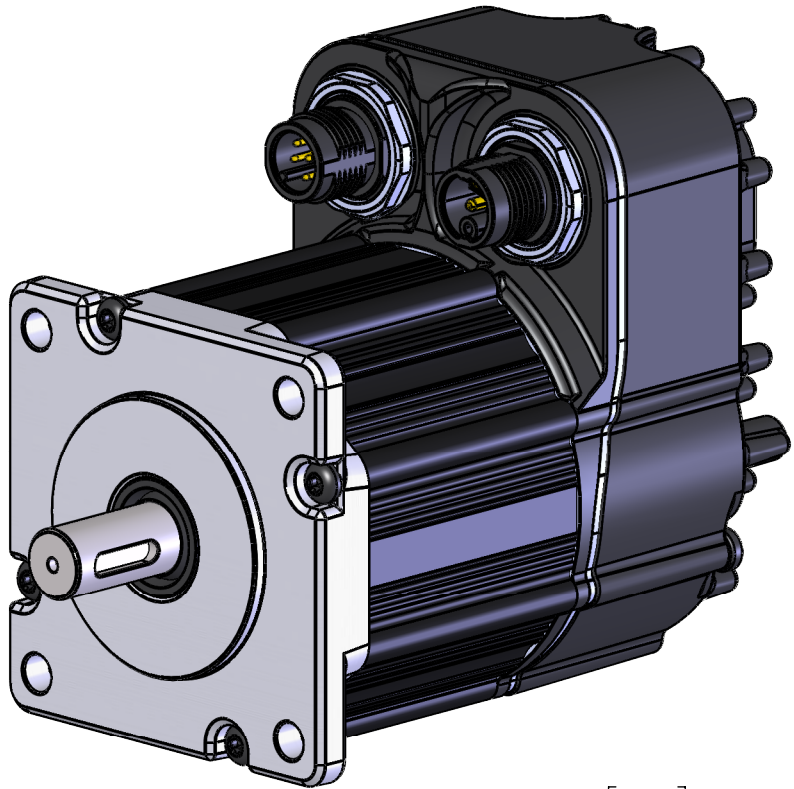
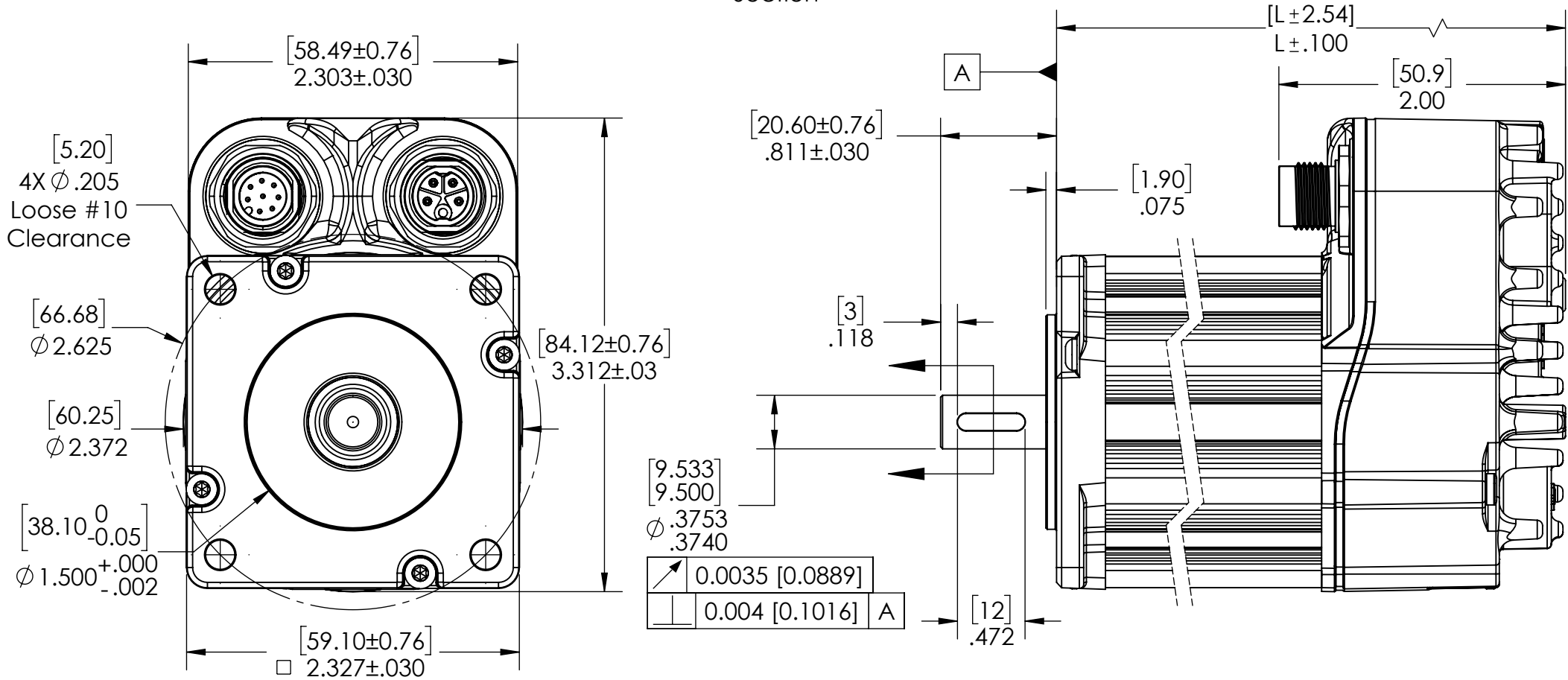

**Teknic, Incorporated**  
Victor, NY 14564 USA

This document and related electronic files are the sole property of Teknic, Incorporated and contain proprietary information.

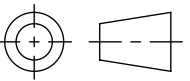
  
Third-Angle Projection

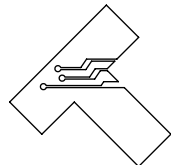

Additional documentation including product specifications, up-to-date compliance information, and manuals can be downloaded from Teknic's website.  
Visit <https://www.teknic.com/> to access that documentation.

DWG. NO./REV

TITLE: 23xx ClearPath IP66K/IP67 Motor Family

1 of 3 Sheets

# USB-IR Converter

## P/N: CPMS-USB-IR

All dimensions are in inch [mm] unless otherwise noted.  
Sheet Scale 2:1

Unless otherwise specified, untoleranced dimensions default to:  
**X.X:** ± 0.020" [.5mm]  
**X.XX:** ± 0.010" [.25mm]

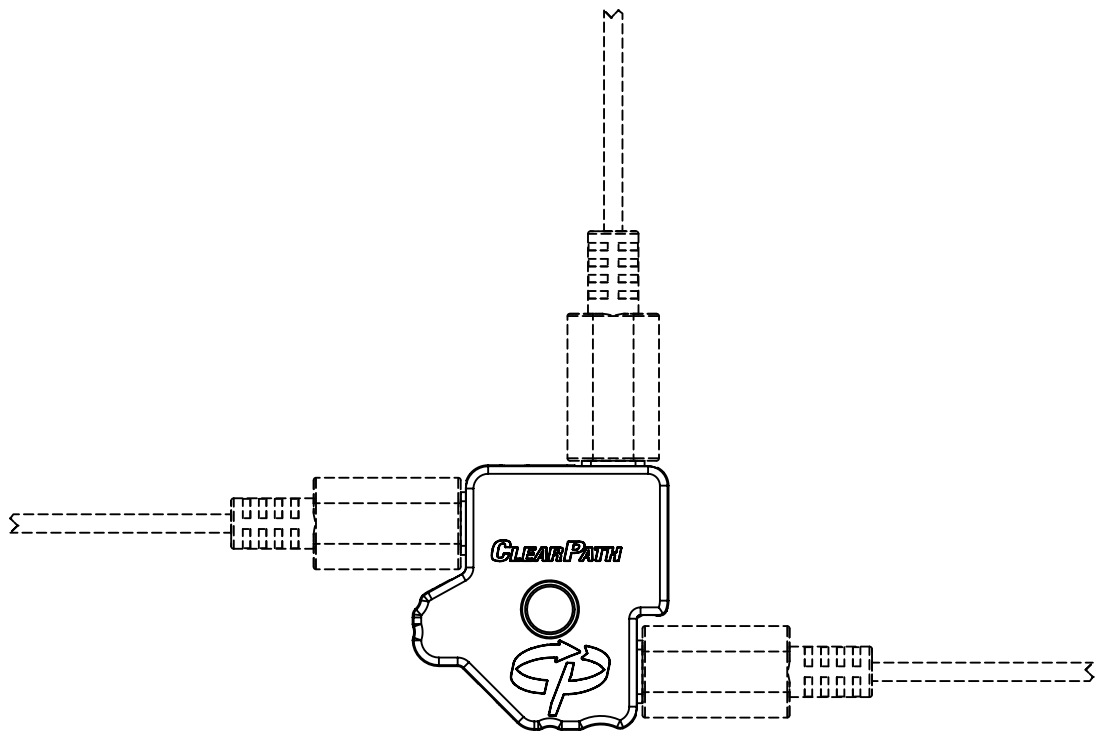

To allow easy connection in multiple orientations, a USB-C cable can be plugged into any one of three locations.  
(Cables not Included)  
Scale 1:1

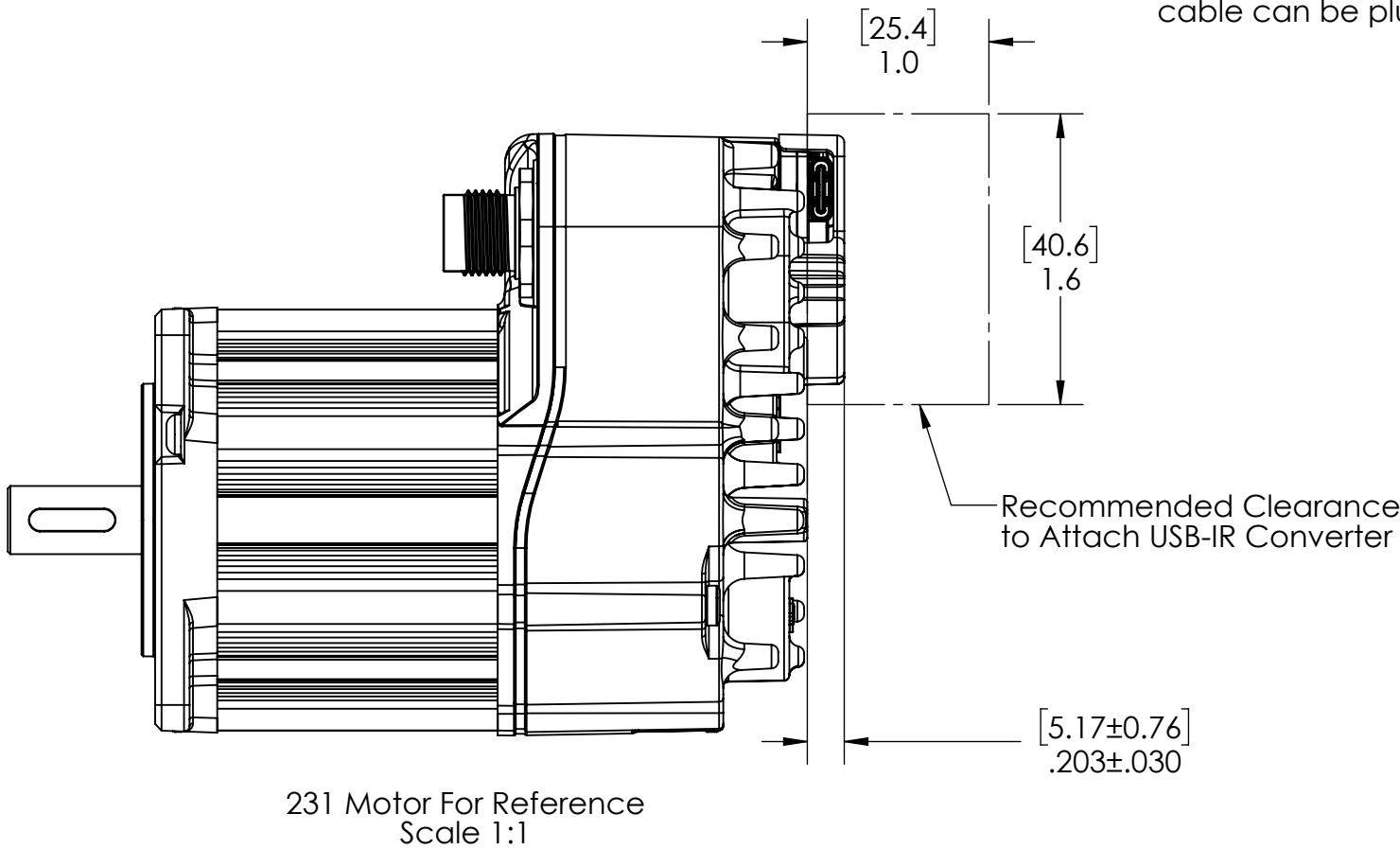
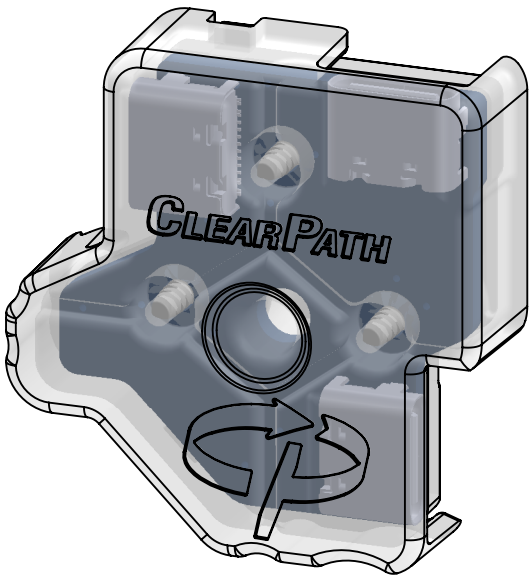

231 Motor For Reference  
Scale 1:1

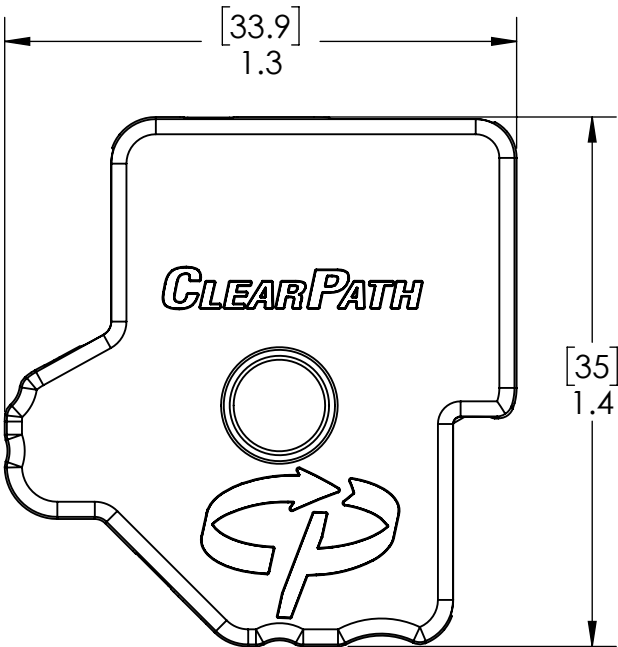
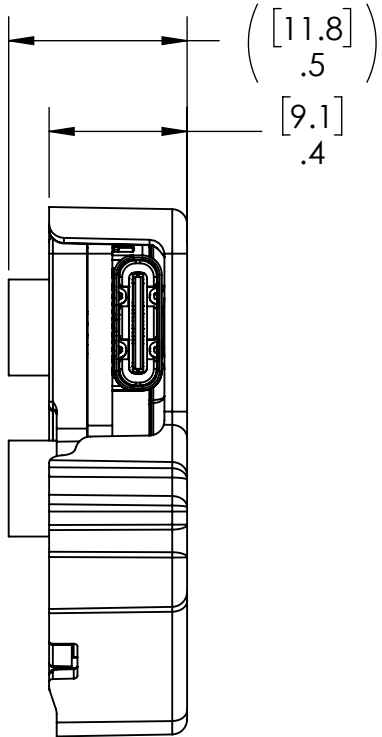

**Teknic, Incorporated**  
Victor, NY 14564 USA

This document and related electronic files are the sole property of Teknic, Incorporated and contain proprietary information.

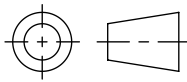
  
Third-Angle Projection

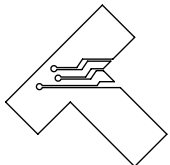

Additional documentation including product specifications, up-to-date compliance information, and manuals can be downloaded from Teknic's website.  
Visit <https://www.teknic.com/> to access that documentation.

DWG. NO./REV  
D1229/C

TITLE: 23xx ClearPath IP66K/IP67 Motor Family

2  
of 3  
Sheets

# USB-IR Port Cover

## P/N: CPM-COVER-USB-5PC

Package of five (5) covers.

All dimensions are in inch [mm] unless otherwise noted.  
Sheet Scale 2:1

Unless otherwise specified, untoleranced  
dimensions default to:  
**X.X: ± 0.020" [.5mm]**  
**X.XX: ± 0.010" [.25mm]**

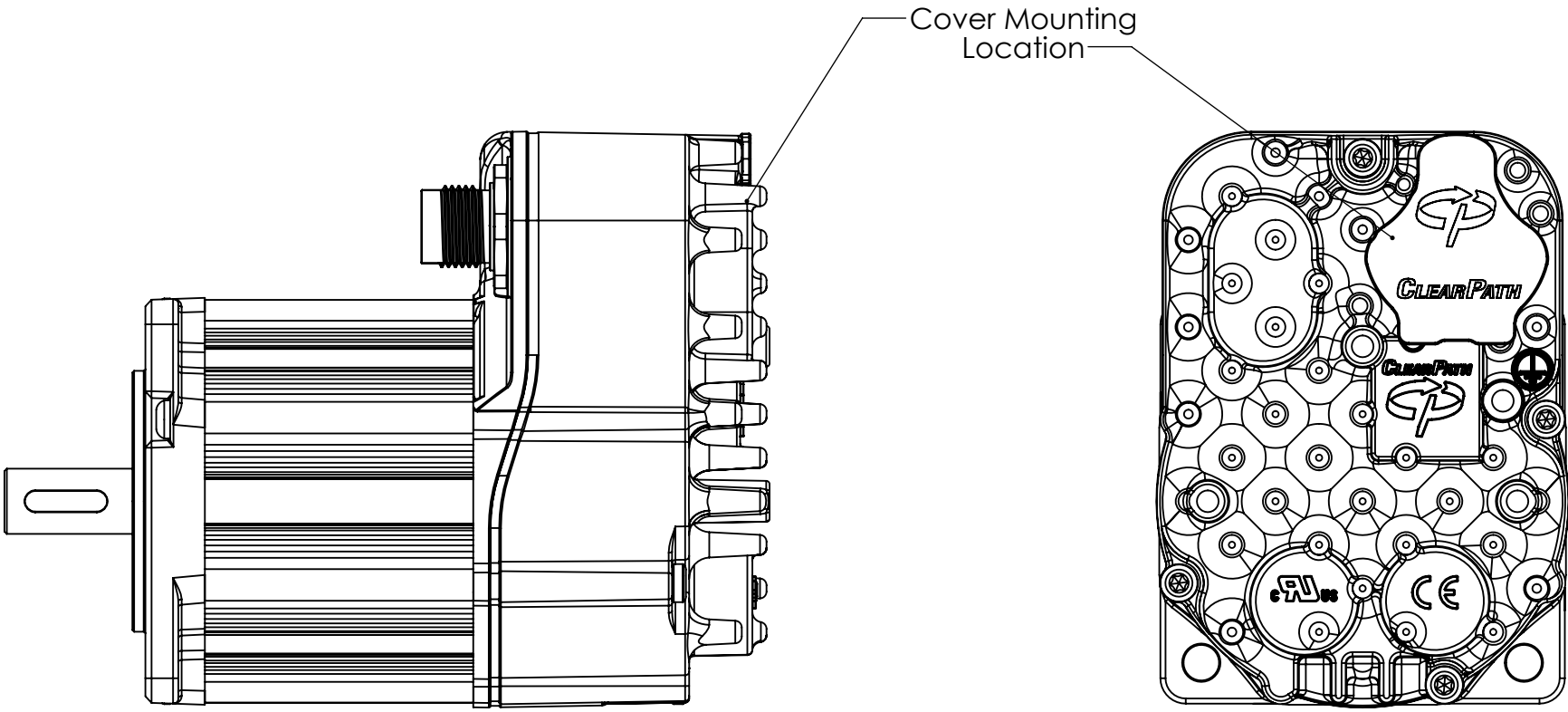

231 Motor For Reference  
Scale 1:1

231 Motor For Reference  
Scale 1:1

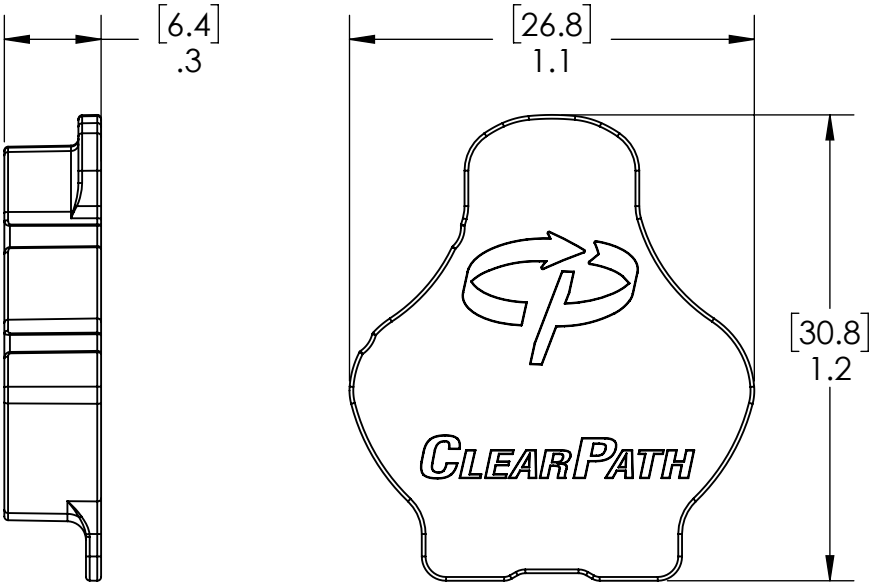

**Teknic, Incorporated**  
Victor, NY 14564 USA

This document and related electronic files are the sole property of Teknic, Incorporated and contain proprietary information.

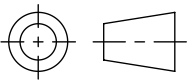

Third-Angle Projection

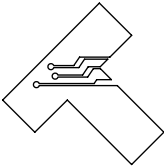

Additional documentation including product specifications, up-to-date compliance information, and manuals can be downloaded from Teknic's website.  
Visit <https://www.teknic.com/> to access that documentation.

D1229/C

DWG.  
NO./REV

TITLE: 23xx ClearPath IP66K/IP67 Motor Family

**3**  
of 3  
Sheets